

MOORE PARK EAST

LANDSCAPE PLAN

APRIL 2023





Greater Sydney Parklands acknowledges the Traditional Custodians of the lands, waters and sky of Dharug, Gundungurra, Dharawal and Eora Country and pays respect to the Elders of these lands past, present and emerging. We recognise First Nations Peoples' unique cultural and spiritual relationships to place and their rich contribution to society.

We acknowledge the rights and interests of First Nations Peoples to be involved in the ongoing management of these traditional lands. We will work in a respectful manner with Traditional Custodians, Local Aboriginal Land Councils and First Nations communities of Greater Sydney to facilitate and support their custodianship of the parklands' natural and cultural heritage and to ensure our parklands are places in which First Nations Peoples are included socially, culturally and economically.

Moore Park East balances growing recreational community needs including sport, play and entertainment, while promoting healthy lifestyles through active links both to and within the park.

Table of Contents

THE PLACE - ABOUT MOORE PARK EAST

Natural and Pre-contact Cultural Heritage of	6
Moore Park Urban Context	7
Neighbourhood Context	8
Our Opportunity	9
Planning Context	10

THE PROCESS - LISTENING TO COUNTRY AND COMMUNITY

Community Consultation Summary	13
Key Feedback Themes	14
Landscape Plan	16

DESIGN PRINCIPLES - SHAPING MOORE PARK EAST

Contemporary Country	18
Clear Connections	19
A Park for Everyone	20
A Seasonally Beautiful Park	21
Anchoring Sports in the Community	23

KEY AREAS - EXPLORING MOORE PARK EAST

Village Green	25
Kippax Lake	28
Driver Avenue	31
Active Play	35

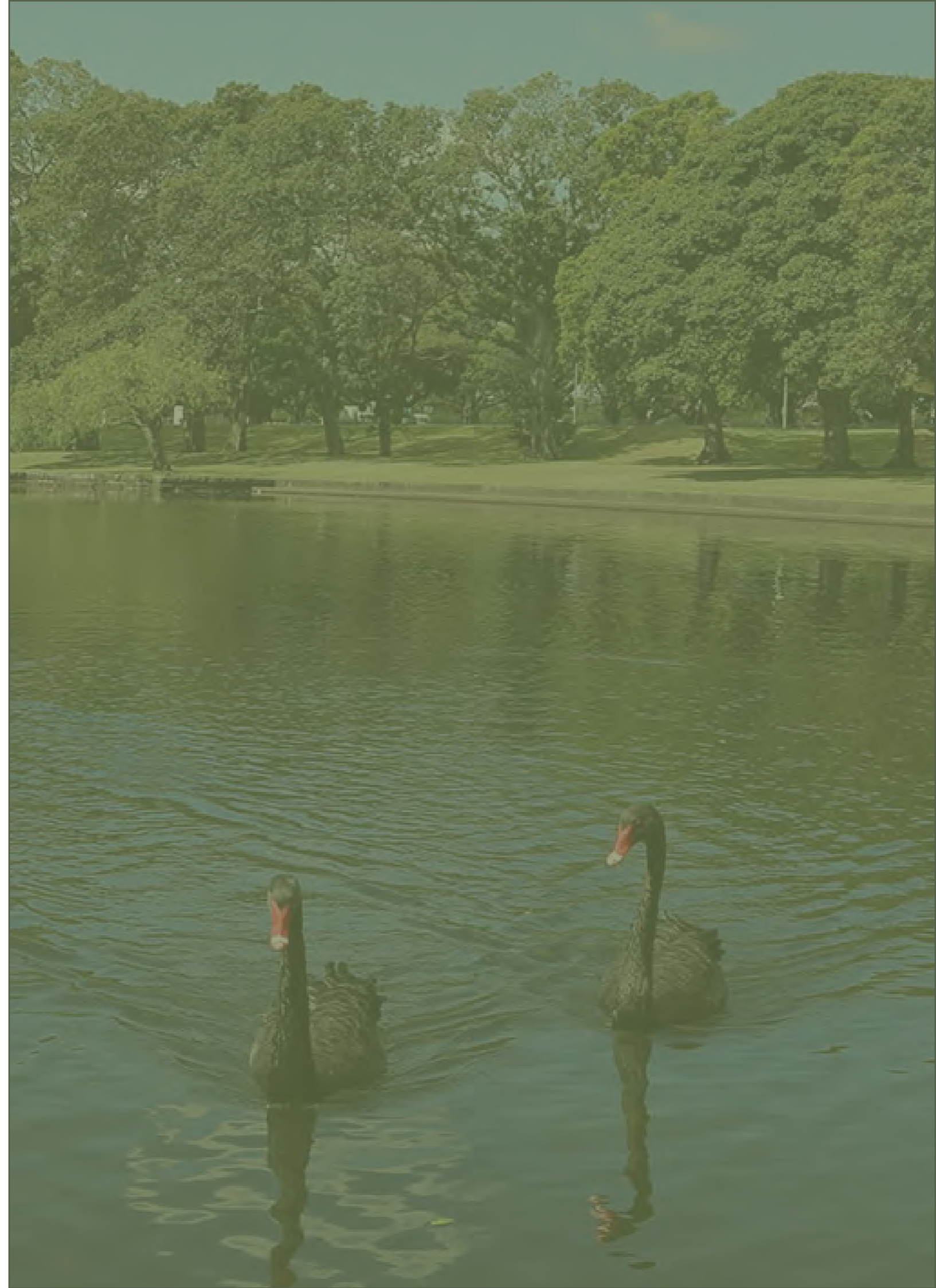



1 THE PLACE ABOUT MOORE PARK EAST

Natural and Cultural Heritage

Greater Sydney Parklands (GSP) acknowledges the Gadigal people of the Eora Nation as the traditional custodians of the Country on which the Parklands has been constructed. As part of our custodianship role, we wish to continue moving forward in a respectful partnership with the community in Caring for Country together.



Wetlands and Sand Dunes

Prior to the impact of British colonists the Moore Park area contained rich ecological diversity in the form of wetlands, swamplands, woodlands and sandhills.

One of the key wetlands in this system was the Lachlan Swamps, an extensive system that once covered 6000 hectares with some areas still present within Centennial Park. Moore Park was formed on the western edge of the Lachlan Swamps.

... a swamp heathland mosaic of Eastern Suburbs Banksia Scrub (ESBS) growing on sand dunes and ridges, interspersed with estuarine and freshwater wetlands...
Hamilton & Penny, 2014:86



Lagoons and Soaks

The Freshwater lagoons and soaks that characterised the Country around Moore Park can be seen in this early map of the area (1820-1840). That includes the current suburbs of Redfern, Chippendale, Centennial Park, Alexandria and Zetland.

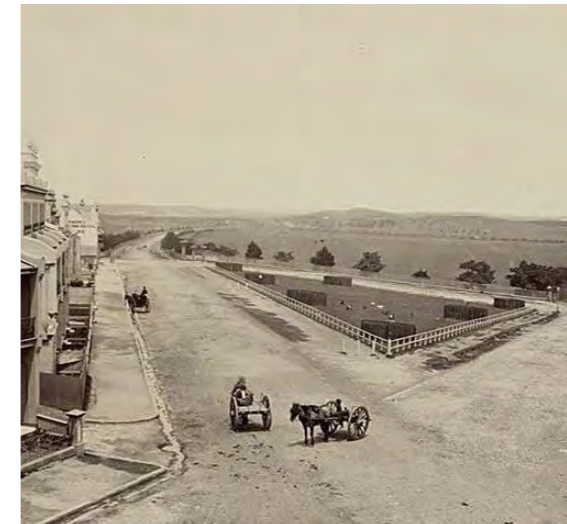

Movement Corridors (Pathways)

Movement corridors (pathways) connect people and Country facilitating complex social, ceremonial and economic networks.

There are many movement corridors that connect the Country around Moore Park with others parts of Country including significant cultural and ceremonial places such as those at Hyde Park, the Brickfields, Prince Alfred Park, Farm Cove, Long Bat and Botany Bay.



Resource Country

The wetlands and dunefields of the Moore Park Country held abundant plant and animal life with the plant life being both edible and useful for other resource purposes such as the construction of tools and weapons.

... The extensive sheets of fresh water, the luxuriance of the vegetation in the bottoms and along the edges of the lakes and creeks, and perhaps even the huge mounds of loose sand in which it was so easy to make a nest and which was always dry... The Echo, 12 June 1890

1 The Place

About Moore Park East

Urban Context

Centennial Parklands encompasses Centennial Park, Moore Park (including the Entertainment Precinct) and Queens Park, in total around 360 hectares. The three main parks (excluding the Entertainment Precinct) are listed on the State Heritage Register of NSW, and various components within the Parklands are of national, state or local heritage significance.

Centennial Parklands is approximately 5 km south-east of Sydney's central business district. The boundaries of the Parklands are across or adjacent to four local government authorities:

- City of Sydney
- Randwick City Council
- Woollahra Municipal Council
- Waverley Council

With more than 30 million visits per year, Centennial Parklands is one of the world's leading public parklands. In Sydney it is known as 'the lungs of the city'. Part of Greater Sydney Parklands, it also contains some of the most historically and socially significant urban spaces in Australia.



Moore Park East urban context

1 The Place

About Moore Park East

Neighbourhood Context

Moore Park East is a 22-hectare portion of the 115-hectare regional park, Moore Park.

It provides open space amenity to multiple high-density, inner-city residential and mixed-use suburbs of Sydney's inner city.

Population numbers from 2021 Census

Waterloo Zetland	32 248
Redfern	15 255
Surry Hill	17 894
Darlinghurst	12 853
Paddington	12 911
Centennial Park	2 376

It provides access to the Randwick – Circular Quay Light Rail service at the Moore Park stop and to Tibby Cotter Bridge, a generous pedestrian and cycling connection to Surry Hills over Anzac Parade. The park also provides home training fields for professional sporting teams the Sydney Swans (AFL) and the Sydney Roosters (rugby league).

It is a multifunctional and historic park in a constrained urban environment, that endeavors to balance the needs of the local community as well as the major entertainment and sporting stadia adjacent.

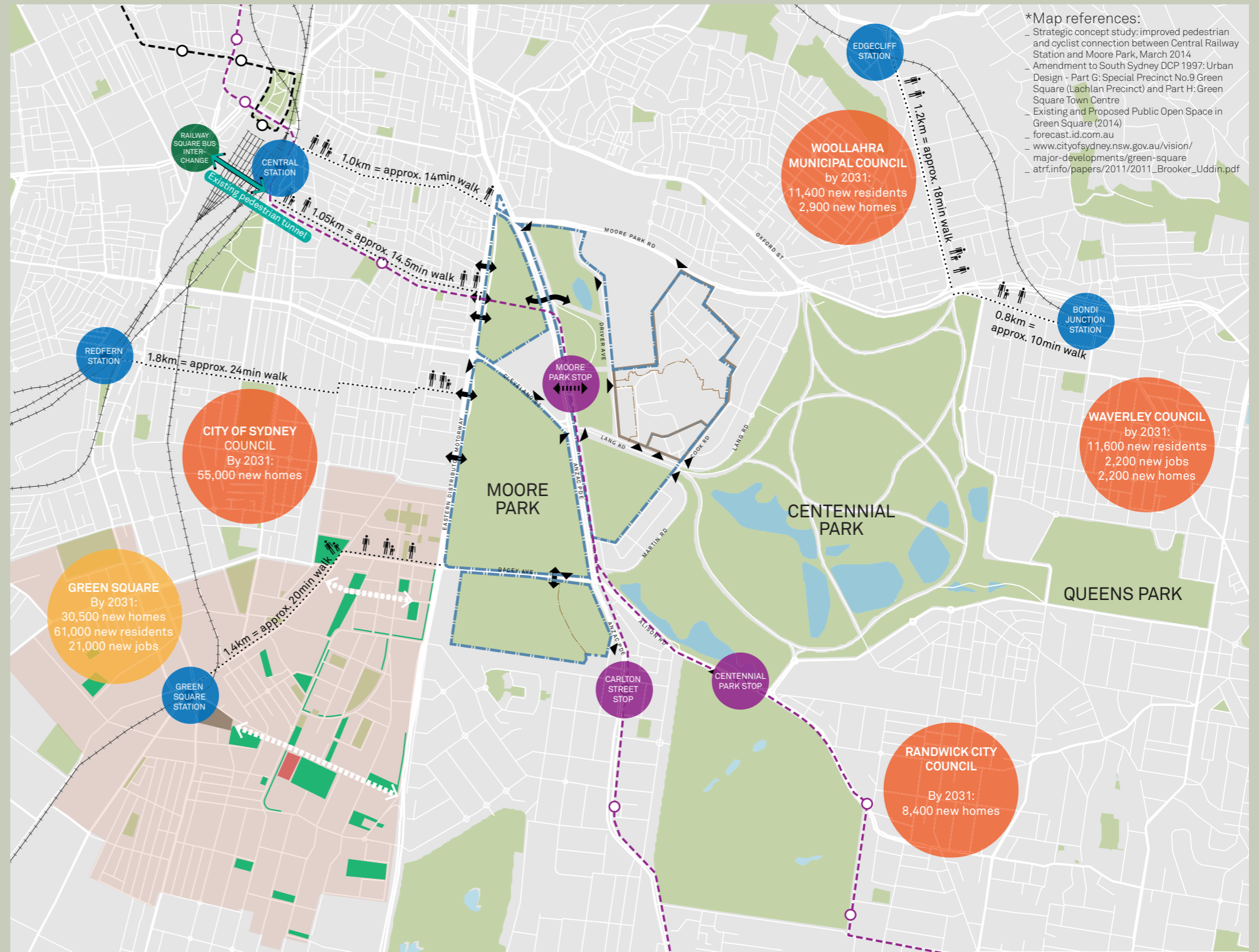

Existing pedestrian and public transportation network including planned capital works project and projected population in surrounding areas

Moore Park Master Plan 2040

1 The Place

About Moore Park East

Our Opportunity

In the wake of the COVID-19 pandemic we have a whole new appreciation for how important public spaces are for individual and community well-being. They are the places where community comes alive, where connections are strengthened, experiences are shared and a sense of belonging is fostered.

As the density of our inner-city areas increase, so does the demand for open space, and our existing public spaces must be protected, and adaptable, to provide the environmental and recreational amenity we need to maintain healthy lifestyles now, and for generations to come.

Moore Park East has long been a destination for sport and physical activity but it's availability for passive recreation and overall landscape quality has been limited by its secondary function as an event overflow parking area.

The GSPT Act 2022 has provided the legislation necessary to permanently remove carparking from the park and the Sydney Football Stadium Redevelopment includes a purpose-built facility (off Driver Avenue), providing Greater Sydney Parkland's with a unique opportunity to revitalise Moore Park East.

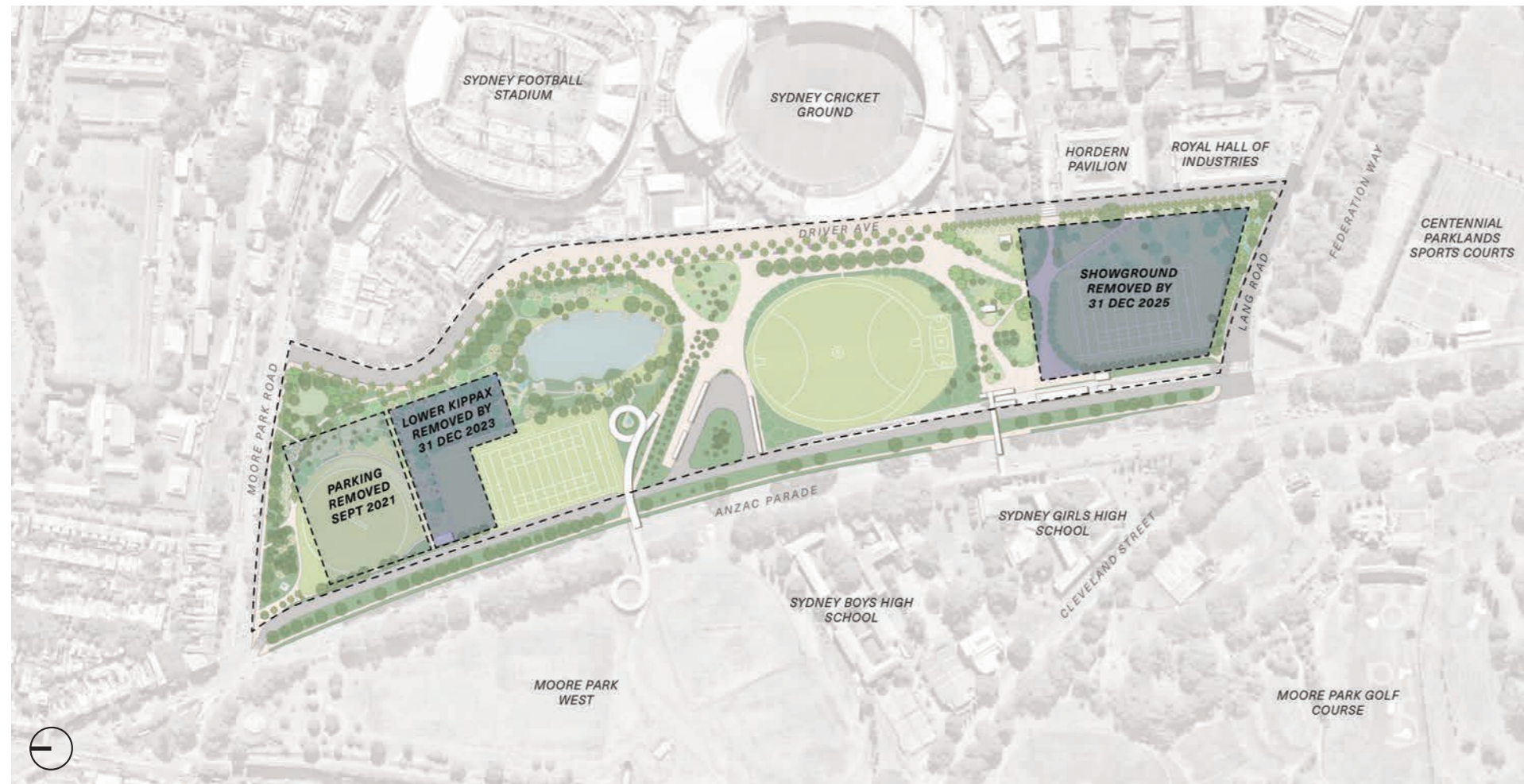

The Moore Park East precinct is bounded by Moore Park Road to the north Lang Road to the south, Anzac Parade to the west and sports and entertainment precincts to the east. The Precinct includes Driver Avenue along its eastern boundary. Carparking removal as legislated in the Greater Sydney Parklands Trust Act 9 2022.

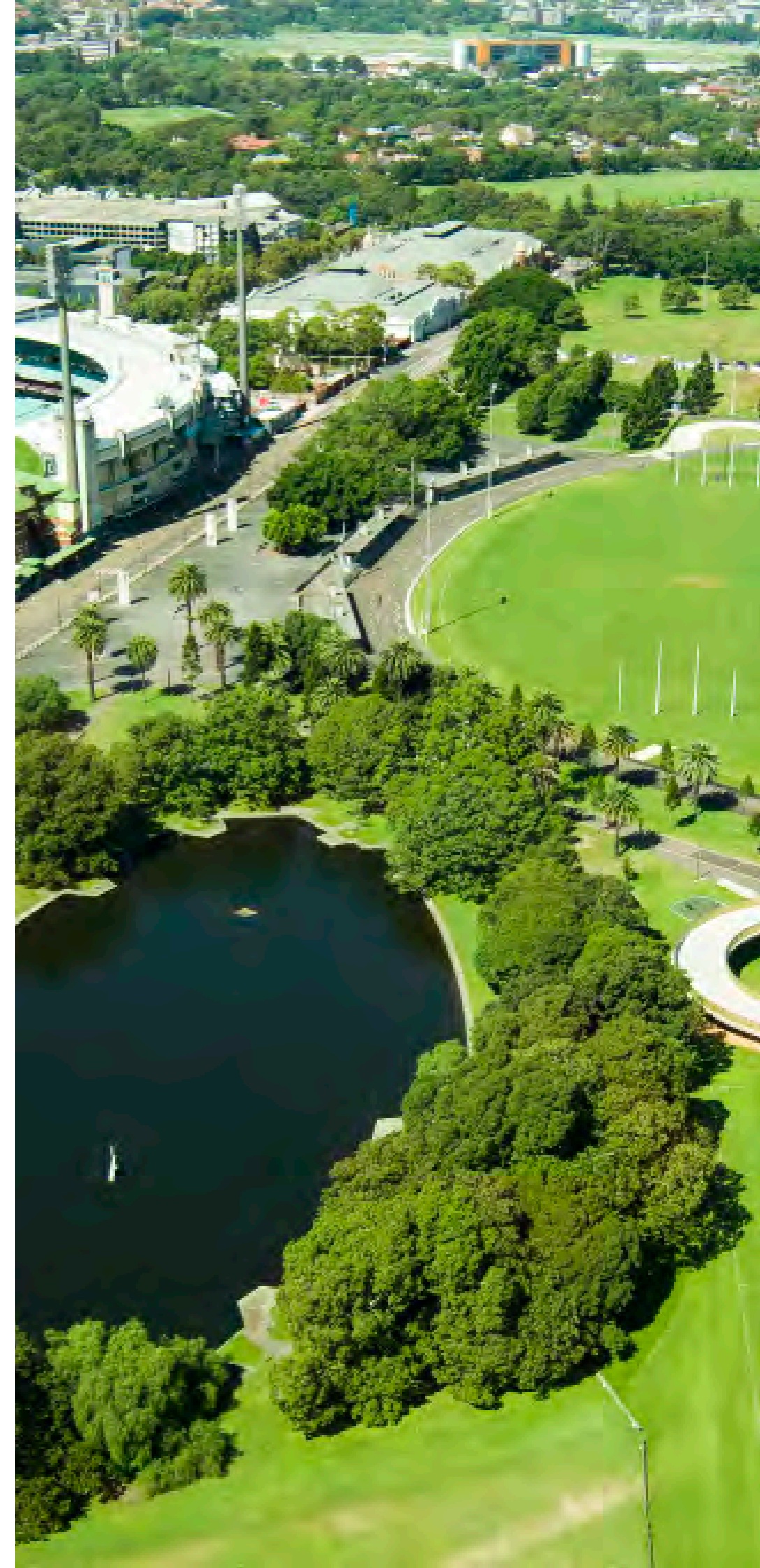

1 The Place

About Moore Park East

Planning Context

The Moore Park Master plan 2040 (2017) has been a foundational guide for the creation of the Moore Park East Landscape Plan. It translates the strategic objectives and vision of the master plan as a 'park for everyone' through place-based design, ground-truthed through consultation and engagement.

The landscape plan shows how we can provide greater community amenity through:

- More trees and 'greening' of the Park
- Improved access for pedestrians and cyclists
- Greater provision for passive recreation
- Greater emphasis on Aboriginal heritage and culture
- Proposed new and enhanced facilities for high performance and community sport
- Integration with the Light Rail network - prioritising pedestrian safety during event mode

The proposed landscape renewal at Moore Park East contributes to the ambition for Greater Sydney to be home to quality parklands, a greater network of connections to green open spaces and an ongoing commitment to caring for the environment, as set out in the NSW Government's 50-year Vision for Greater Sydney's Open Space and Parklands.

The Moore Park East Landscape Plan sits within a greater Plan of Management for Centennial Parklands that includes Centennial Park and Queens Park. The landscape plan will align itself with the overall strategic vision for the Park to secure its sustainable future.

Centennial Parklands' Planning Framework

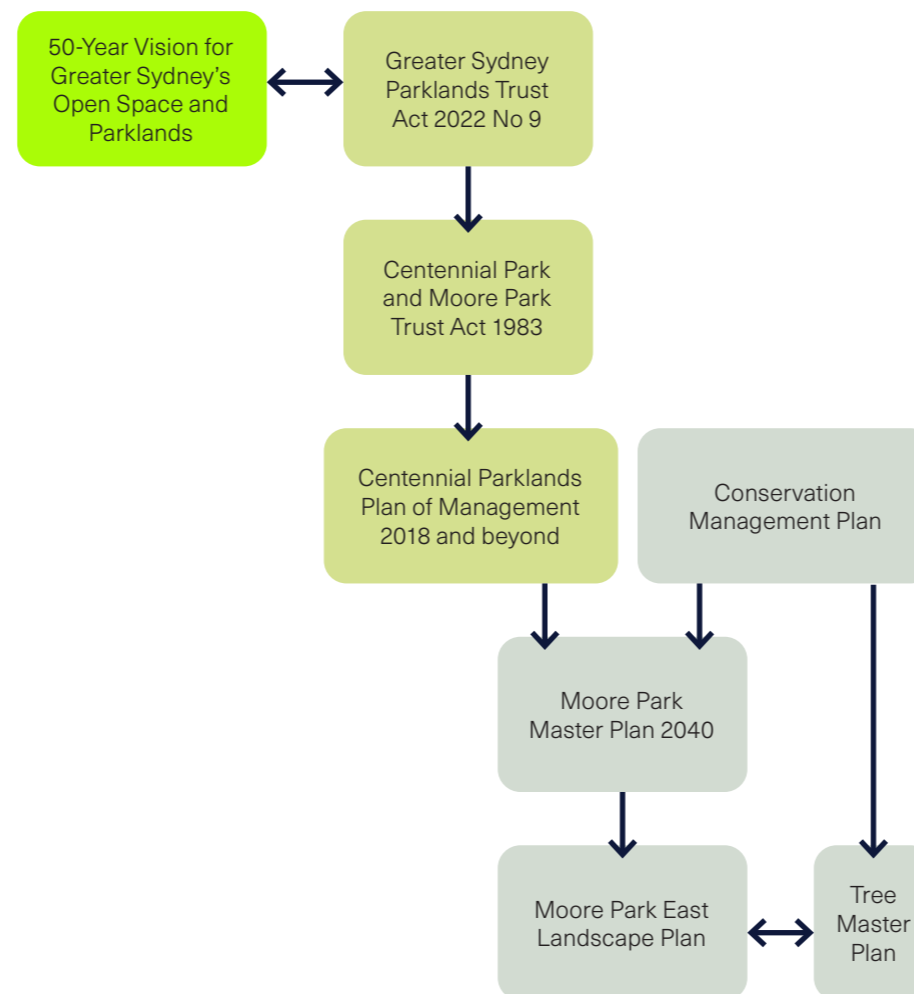

Moore Park Master Plan 2040

Moore Park is one of Australia's most significant parks and is widely loved as part of inner Sydney's 'green lungs'. It includes magnificent landscapes and significant heritage features across 115 hectares of public open space.

Building a strong vision of 'A place for everyone', the Master Plan sets out the framework for the sustainable use, management and renewal of Moore Park, while protecting its core values.

The Master Plan outlines four guiding principles:

1. Preserving the green space and heritage; conserve the green space and protect the Park's natural, built and cultural heritage.
2. Better connected and more permeable; increase public access to and across the Park while breaking down barriers to pedestrian and cyclist flow.
3. Improved visitation and participation; a place for all to play; balancing community and high-performance sports and leisure activities with world-class entertainment and events.
4. Improving sustainability; strengthen the Park's social, environmental and financial sustainability.

Moore Park Key Takeouts

- Create an Entertainment Boulevard with pedestrian and cycle priority along Driver Avenue
- Improve pedestrian and cycle access to Entertainment Quarter and sports stadia
- Continuous pedestrian and cyclist paths
- Enhance green open space following the progressive removal of the temporary event on-grass parking in Moore Park East
- Maintain, enhance and interpret the historic Kippax Lake while maintaining its importance as a destination for social and cultural activities
- Introduce appropriate aquatic plantings to maintain a healthy aquatic habitat

A vibrant, artistic rendering of a park scene. The foreground is dominated by a large, detailed palm tree on the right, with its fronds extending across the top right. A paved path winds through the center, where several people are walking. The background is filled with more palm trees and greenery, creating a sense of depth and a tropical atmosphere. The overall color palette is rich with greens and browns, with a slight yellowish tint in the sky and path areas.

2 THE PROCESS

LISTENING TO COUNTRY AND COMMUNITY

2 The Process

Listening to Country and Community

Community Consultation

Working with specialist consultants WSP and ASPECT Studios, Greater Sydney Parklands has undertaken extensive and extended community and stakeholder engagement to best capture community feedback in preparing the Landscape Plan. Consultation and engagement on the draft Landscape Plan for Moore Park East has been carried out in two phases:

Phase 1 (late 2021 to early 2022)

Phase 1 focused on understanding the diverse stakeholder and community hopes and needs for Moore Park East. Phase 1 included two design workshops with stakeholders and community representatives, a range of meetings with key stakeholders and sporting groups, and a First Nations Consultation program carried out by Yerrabingin. Feedback from Phase 1 shaped the draft Landscape Plan.

Phase 2 (22 July and 11 September 2022)

In Phase 2, GSP consulted with stakeholders and the wider community on the key themes, opportunities and changes proposed in the draft Landscape Plan. The consultation period was extended to over a seven-week period from 22 July to 11 September 2022. Feedback from Phase 2 shaped the final Landscape Plan.

In 2016, consultation was undertaken for the formulation of the adopted Moore Park Master Plan 2040.

Project Timeline



Next Steps

- Greater Sydney Parklands Board Approval of Moore Park East Landscape Plan (completed 22nd of December 2022)
- Develop delivery plan and prepare for staged implementation works
- Develop detailed design and approvals for Stage 1 priority projects (\$2M)
- Prepare detailed technical investigations and studies
- Develop remediation action plan
- Detailed technical investigations and studies
- Progress statutory approvals for future projects as funding becomes available
- Continue to update stakeholders and community as future works are detailed and programmed for delivery



'Walk-shop' with local Aboriginal community at Moore Park East

2 The Process

Listening to Country and Community

Listening to Country

The Wanganni Dhayar (Listen to Country) design methodology developed by Yerrabingin is aligned to the principles outlined in the GANSW Connecting with Country framework. Rather than a traditional consultation or engagement, Country and its custodians are active co-designers of the project through a shared collective voice instead of a series of individual representations.

On March 28th, 2022, GSP invited the local Aboriginal community out to join us for a 'walk-shop' on site with ASPECT Studios. Uncle Ray Davison (Community Elder) and Jordan Ardler, Aboriginal Graphic Designer joined us to walk the site and discuss design opportunities.

An amazing story was also shared by Uncle Ray who spent his younger years in this area running up and down sand dunes and playing in the water in between. There is an opportunity for this project to showcase what this landscape was to acknowledge the endemic landscape and ecology as well as to educate those visiting and spending time in the park.

Yerrabingin Outcomes Report, 2022.

After this workshop Yerrabingin continued to speak with Uncle Ray weekly, updating him on the project's progress as well as adding his extra thoughts and ideas. They also had several few online discussions with Uncle Ray's grandson, Cameron, about his ideas on the project also. Cameron spoke passionately about the local ecology in the area and the importance it has on the biodiversity and ecosystem of the site.

Listening to Community

The Phase 2 consultation and engagement approach (July to September 2022) was designed to reach and encourage feedback from stakeholders and community members to inform the development of the final Landscape Plan. The approach considered previous stakeholder and community conversations about the future of the area (including Moore Park Master Plan 2040 consultation in 2015/2016) and invited fresh ideas for Moore Park East.

An online survey broadened the reach of engagement to time-poor but interested members of the community. Webinars overcame some of the accessibility barriers experienced by some stakeholders and community members.

All ideas about the future of Moore Park East were welcomed and considered. Key elements of the engagement approach:

- Two pop-up events at Moore Park East
 - One sporting group webinar
 - A community webinar
 - A briefing with AMPS
 - Briefings with two local community groups
 - A briefing with City of Sydney
 - Online survey
 - Invitations for submissions (including illustrations and written submissions)
- 2,877 Visits to the website
 - 249 Survey responses
 - 70 Pop-up attendees
 - 44 Submissions (including key stakeholders: City of Sydney Council, Woollahra Council, Paddington Darlinghurst Community Group, The Paddington Society, Crown Street Public School (Enviro Warriors), Cricket NSW, Eastern Suburbs Football Association, AFLNSW, TfNSW, Transdev and BIKEast)
 - 40 Community webinar attendees
 - 5 Sports webinar attendees



'Walk-shop' with local Aboriginal community at Moore Park East



Pop-up community consultation at Moore Park East

Key Feedback Themes

The key themes raised by stakeholders and community combine qualitative feedback – submissions, open ended survey questions and verbal feedback shared in conversation with the project team at engagement events. The following themes are a high-level snapshot of what we heard:



Removal of Parking

There was strong support for the NSW Government's commitment to remove parking from the grassed area of the park by 2025. Park users look forward to making better use of this public space. Some participants raised concerns about where visitors will park their cars and whether this decision will cause congestion on local streets.



Dog-friendly Areas

There was strong support for dog-friendly areas in the park, including options for off-leash or fenced dog-play areas. Several respondents said that planning for the park will need to balance the needs of dog owners while ensuring the protection of local wildlife.



Community Use

Many participants were pleased to see improved spaces for community use. It was suggested that community uses be prioritised at the park, over special event or elite facilities. Many people said they would like to see places to gather or relax, including picnic spots, barbeques and shaded seating. Others called for better toilet facilities and a café.



Children's Play Areas

There was strong support for a children's play area. While some participants would like to see 'wild play' opportunities, others called for traditional playground equipment such as swings, with fences for safety.

Key Feedback Themes

The key themes raised by stakeholder and the community have informed the design refinement undertaken to finalise the Landscape Plan.



Increased Planting

Many participants said they would like to see more planting at Moore Park East, in particular native planting. These participants said planting will beautify and soften the landscape, while promoting biodiversity and welcoming native wildlife. There was strong support for improving and protecting the natural environment at Moore Park East.



Protection of Wildlife

Many participants mentioned the importance of protecting wildlife, including the Black Swans in Kippax Lake. There was strong support for introducing measures to keep the swans safe and to increase their food sources. These suggestions included fencing around the lake, the planting of native reeds and the construction of an island within the lake.



Sporting Fields

There was mixed feedback on sporting fields at Moore Park East. While there was support for greater community access to sporting fields, some participants suggested there are too many sporting fields and too much high-performance use at Moore Park East. There was interest in cricket nets for casual play or community sport.



Improved Connections

Diverse suggestions were received as to how GSP can improve connections and connectivity at Moore Park East. Suggestions included better cycling, new pathways and lighting. Some participants said GSP need to find the right balance between making footpaths wide enough to meet the needs of sports goers and the amount of hard stand surfaces within the park.

2 The Process

Landscape Plan

Legend

- 1 Village Green
- 2 Parklands Entrance
- 3 Park Play
- 4 Off-field extension area
- 5 Kippax lake field
- 6 Spectator mound
- 7 Kippax Meadow
- 8 Kippax Lake
- 9 Moore Park East Bus Link
- 10 Meeting Spot
- 11 Tramway Oval
- 12 Tramway Courtyard
- 13 Moore Park Light Rail Link
- 14 Showground Field
- 15 Active Play
- 16 Driver Avenue



Moore Park East Landscape Plan



3 DESIGN PRINCIPLES
SHAPING MOORE PARK EAST

3 Design Principles Shaping Moore Park East

Contemporary Country

A productive collaboration between Yerrabingin and ASPECT Studios has enabled Moore Park East to be approached sensitively and in consultation with the local Aboriginal community. The scheme has established a number of opportunities to weave Country-centred design into the key spaces of Moore Park East, which will be co-designed in future design phases.

Summary

Connecting with Country (Government Architect NSW)

Celebrate the area's historic Civil Rights Movement

Incorporate indigenous knowledge to encourage further understanding of local Aboriginal history

Celebrate and reveal the pre-colonial landscape

Introduce species to celebrate six Aboriginal seasons



MOORE PARK EAST LANDSCAPE PLAN

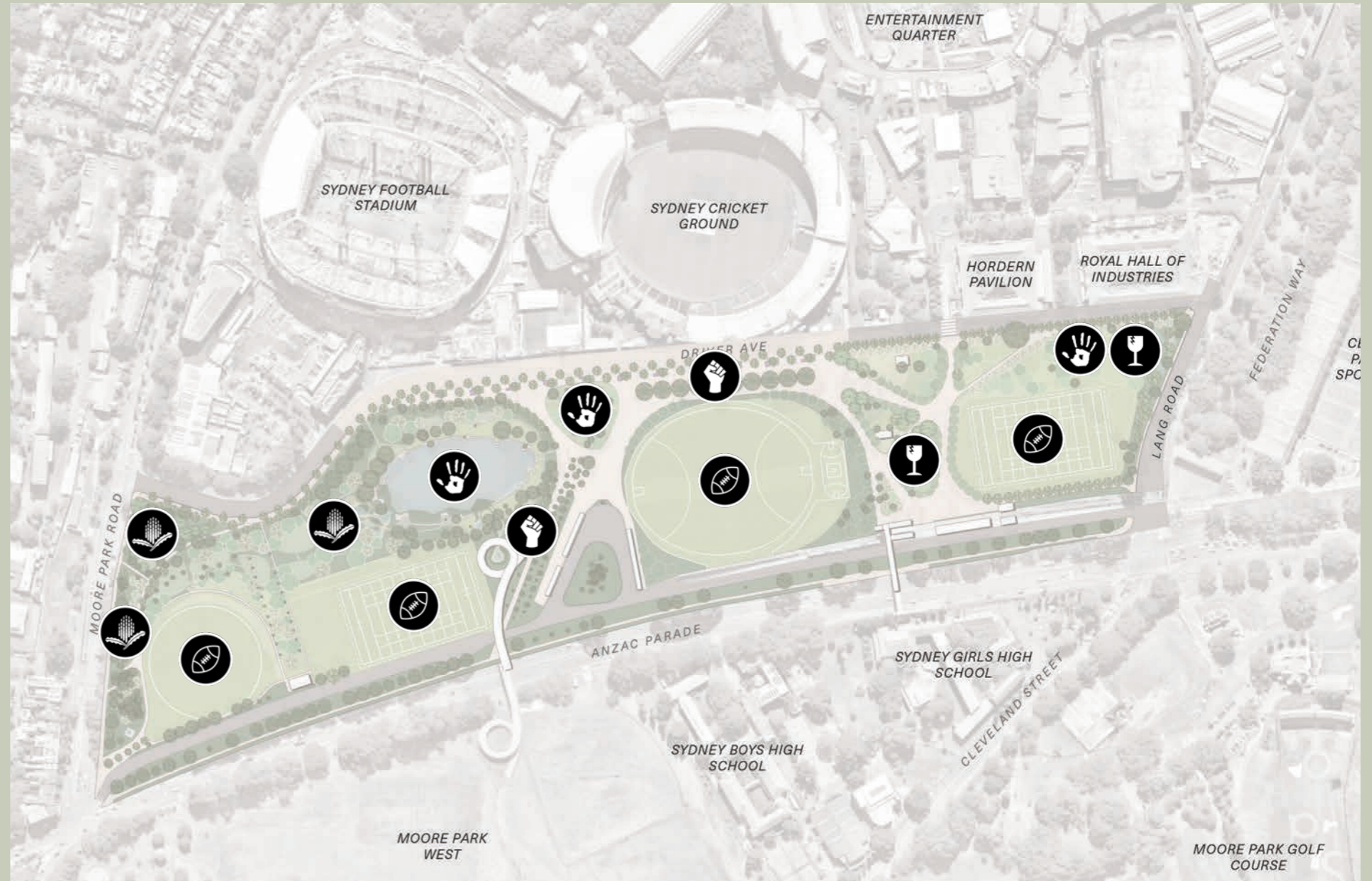

Legend

- Reference to the area's historic civil rights movements
- Opportunities for materiality to reflect the nearby Sydney Glassworks and the Indigenous women who worked there
- Forageable bush tucker gardens containing natural medicinal vegetation referencing the first Aboriginal founded and controlled Medical Service in nearby Redfern
- Naming the sports fields/pathways after key Indigenous sportsman or language that represents the pre-colonial environment or key species (e.g sand dunes, Banksia spp, emus, etc)
- Create culturally safe and inclusive spaces for large gatherings

Language Opportunities (in collaboration with Uncle Ray Davison)

Muru	Path
Ngamuru	Compass to see the way
Marrang	Sand
Ngurra	Camp and bird's nest
Buru	Kangaroo
Wali	Possum
Gunngung	Frog
Maraong	Emu
Garada	Glossy black cockatoo
Daranggara	Cabbage tree palm
Wadanggari	Banksia ericifolia
Baraba	Bullrush
Mulgu	Black Swan
Goolgadie	Grass Tree

3 Design Principles

Shaping Moore Park East

Clear Connections

As an urban park edged by major road and sporting infrastructure, Moore Park East presents a number of movement and connections considerations across multiple scales. This principle outlines the aim for the Landscape Plan to contribute to the connectivity between the fractured landscape of Moore Park, surrounding public spaces and walking and cycling networks near the site.

Summary

Better Connected and more Permeable (Moore Park Master Plan 2040)

- Improve access and safety through wayfinding and lighting strategies
- Establish a hierarchy of movement that supports event day visitors and park locals
- Consider paths as places and create a variety of experiences
- Strengthen connections north to south and east to west
- Define new entrances into the park

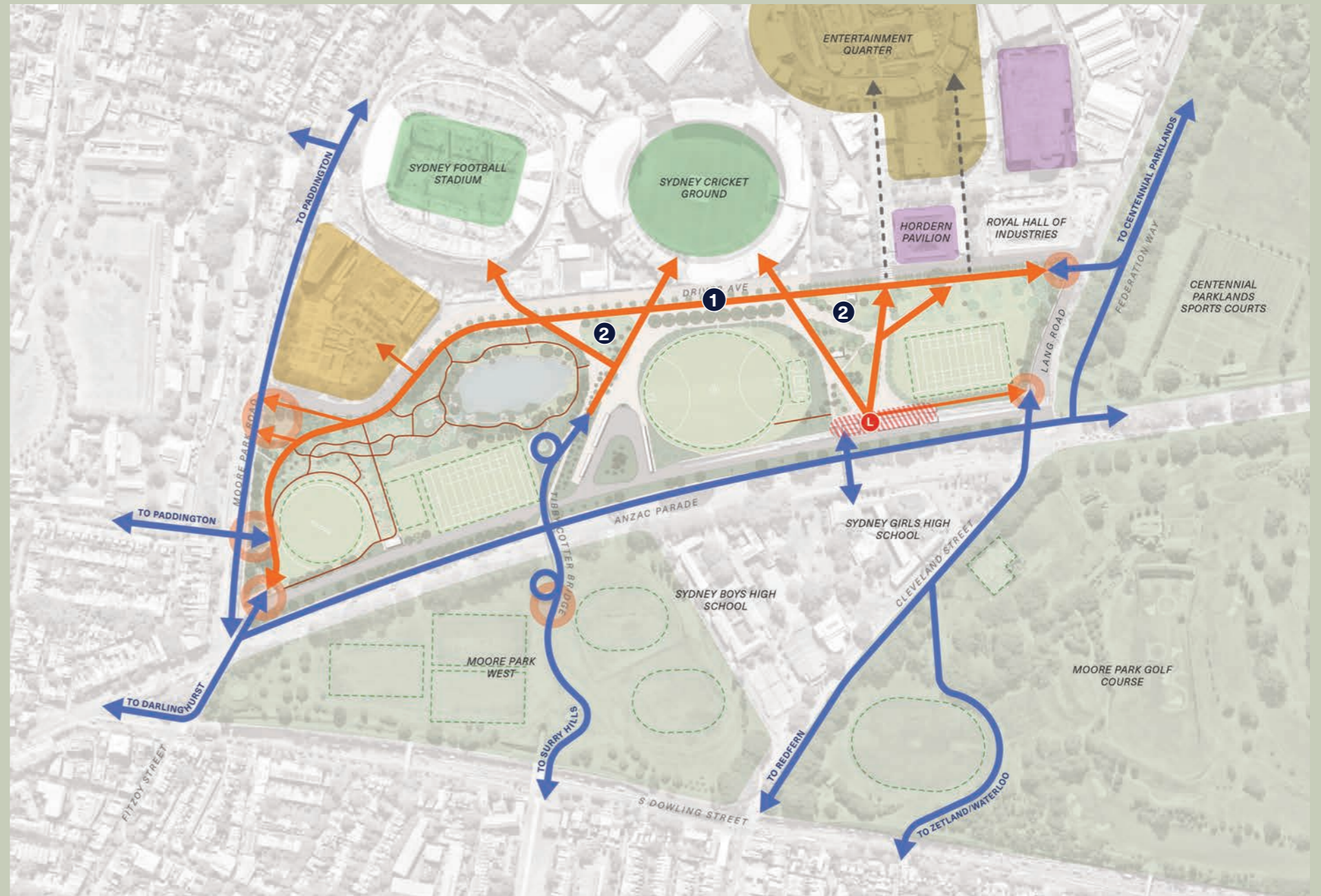

Legend

- 1** Establish a wide footpath parallel to Driver Avenue as a shared pedestrian and cyclist boulevard
- Connect existing infrastructure (light rail, bus stop and Tibby Cotter Bridge) to Driver Avenue and adjacent entertainment buildings with tree lined pedestrian pathways
- Create generous shared pedestrian and cyclist pathways throughout the entire park
- 2** Transform area adjacent to Driver Avenue to programs that cater to all age groups to facilitate event day amenities
- Create an identity and sense of arrival through 'gateways' into Moore Park East
- Establish smaller scale trails and loops throughout Moore Park East to facilitate multipurpose use
- Connecting desire paths to future developments in the wider precinct

3 Design Principles

Shaping Moore Park East

A Park for Everyone

A Park for Everyone recognises that Moore Park East plays a different role for different people. It is important to consider how to increase the park's capacity to support the various needs of a growing community. It's also important to design inclusive and equitable public open space that encourages interaction and social cohesion for all ages, abilities and identities.

Summary

Improved visitation and participation (Moore Park Master Plan 2040)

Create new social places for community by establishing a 'community heart'

Balance sports, community and natural systems

Provide for a greater variety of users including age and ability

Improve a sense of safety through appropriate design (including lighting)



Legend

1 Elevate the presence of community in Moore Park East by establishing a community heart

Establish a 'rhythm' between sports, community and natural systems

 Community facilities

 High performance sport facilities field

2 Celebrate the heritage of Kippax Lake by creating various seating and trail experiences

 Enhance entrance into Moore Park East by establishing a 'Village Green' with accessible entrances, BBQ's, seating and picnic areas

Extend amenity for a variety of age demographics including skate/scooter park + nature play

 Active play

 Nature play

3 Design Principles

Shaping Moore Park East

A Seasonally Beautiful Park

Landscape considerations for Moore Park East balance the need for grassed areas for the community to play in and use, as well as planted areas to increase the beauty and biodiversity of this part of the park. The planting design will enhance the strong perimeter structure of fig trees with new areas identified for native planting, and water-sensitive urban design. It is a priority to provide trees along pathways to create climatically comfortable places for pedestrians and reduce urban heat. GSP supports native vegetation as an important aspect of Connecting with Country to provide bush tucker, education and increased habitat for biodiversity. Protection, retention and replenishment of significant trees at Moore Park East will be in alignment with the Centennial Parklands' Tree Masterplan.

Summary

Preserving the green spaces and heritage (Moore Park Master Plan 2040)

Re-define Moore Park as a parkland that supports biodiversity and natural habitats

Extend Kippax Lake's natural systems by extending water systems and WSUD (water sensitive urban design)

Promote the use of endemic species

Increase shade canopy to reduce urban heat and enhance visitor comfort



Legend

1 Establish Driver Avenue as a primary green link throughout the Moore Park precinct with a planted tree boulevard

2 Integrate primary transport links with Driver Avenue and Entertainment precinct through planted tree boulevard

3 Arrival feature trees at Parkland's entrance

4 Celebrate the heritage of Kippax Lake and its natural systems by extending water systems to increase biodiversity and natural habitat

4 Incorporate site's heritage through integrating existing tree formations along historic tram sheds routes

5 Integrate First Nations' "six seasons" key narrative into planting that is diverse, including flowering shrubs to increase biodiversity

Coastal Freshwater Swamp Forest

Sensory Play

Sculptural Play

Native Botanical Garden

A Seasonally Beautiful Park

Coastal Freshwater Swamp Forest



Acacia longifolia



Banksia integrifolia



Ficinia nodosa



Calochlaena dubia



Ludwigia peploides



Casuarina glauca

Native Botanical Garden



Banksia ericifolia



Banksia serrata



Eriostemon australasius



Darwinia fascicularis



Actinotus helianthii



Kunzea ambigua

Sensory Play



Brachycome multifida

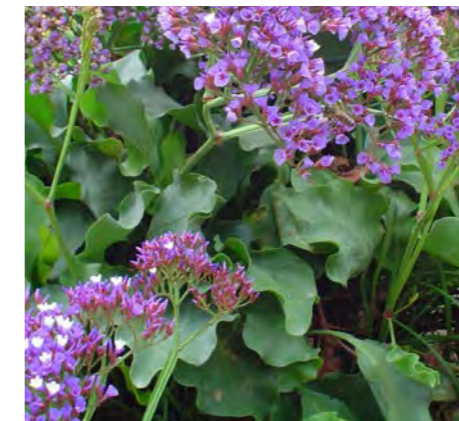

Limonium perezii

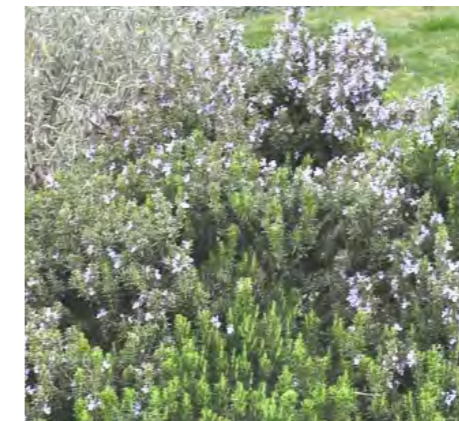

Rosmarinus officinalis 'Dwarf'

Sculptural Play



Crinum asiaticum var pedunculatum



Slvia elegans



Poa labillardieri

3 Design Principles

Shaping Moore Park East

Anchoring Sports in Community

Understanding sport is key to the identity and public amenity of Moore Park. The Landscape Plan aims to increase the variety of exercise options available at Moore Park East, supporting healthy lifestyles for all. The quality and accessibility of high performance sports fields will be improved through field upgrades and increased spectating opportunities, recognising all elements of a strong sporting community.

Summary

Improved visitation and participation (Moore Park Master Plan 2040)

Enrich communities by combining informal fields with community seating and barbecue areas to create a "Village Green"

Create connected active loops that cater to exercise, cycle and play

Encourage community participation through spectating opportunities at high performance training fields

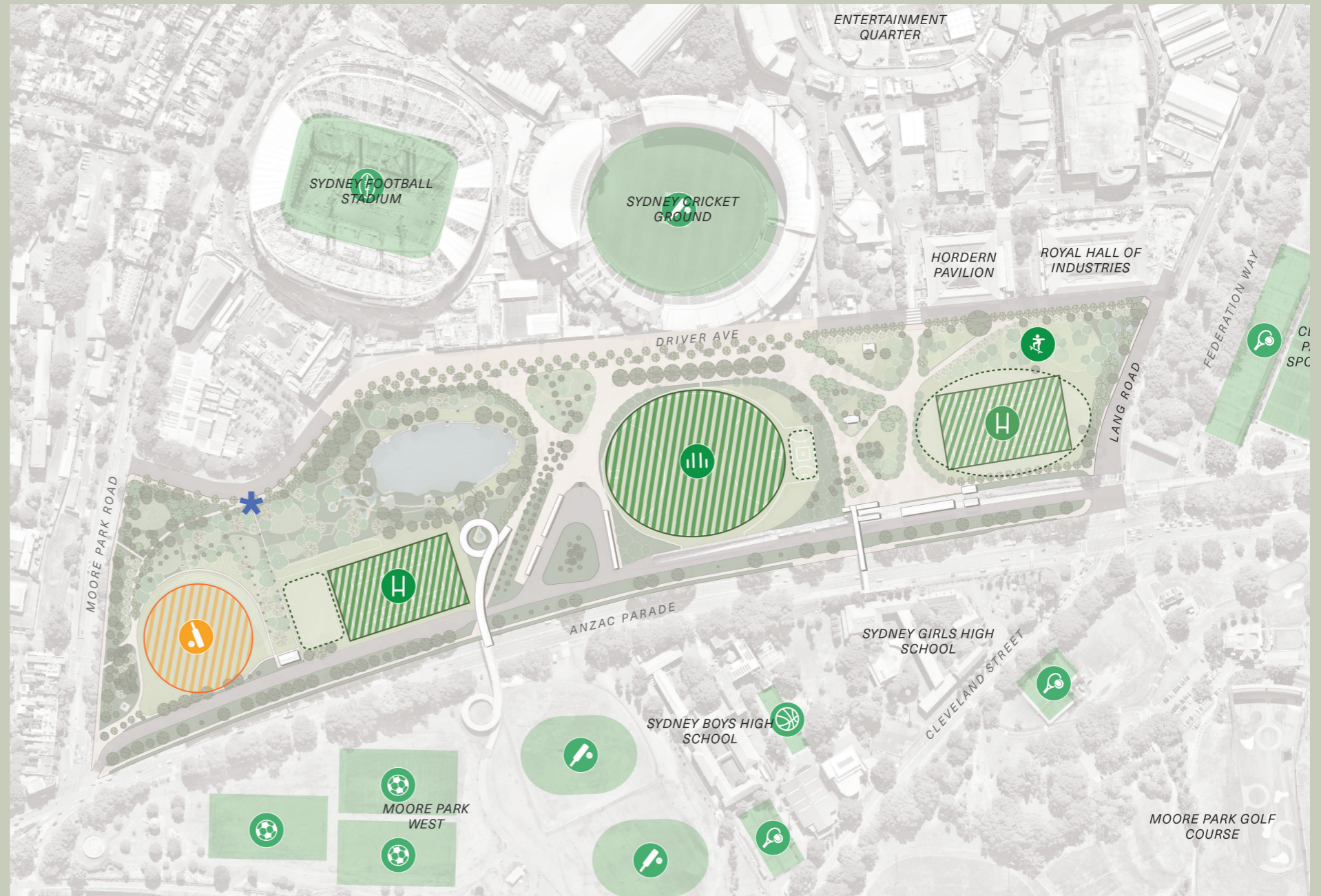

Legend

 Community sports field

 High performance sports field

 Turf area adjacent sporting fields will be available for training and active recreation

 Sports surrounding Moore Park East

 Drop off zone at Driver Avenue

An aerial photograph of Moore Park East, showing a large green field, a winding path, a circular structure, and a body of water. The image is overlaid with a semi-transparent green filter. The text '4 KEY AREAS EXPLORING MOORE PARK EAST' is prominently displayed in the upper left quadrant.

4 KEY AREAS EXPLORING MOORE PARK EAST

4 Key Areas

Exploring Moore Park East

Village Green

A new community heart for Moore Park East. A place to relax, have a picnic with friends and family, read a book or kick a ball around with the kids on the new community oval.

Country-centered Design Opportunities

Learning about and appreciating Country begins in childhood.

Natural and wild play allows children to get messy, to touch, smell, explore, mold, and even taste Country.

Equipment can be inspired by local animals or plant species such as the shape of an emu feather or banksia flower.

Water play and dune fields could educate children about broader ecosystems and what the land used to look like.



Subtle water channels with permeable material



Integrated Nature play for inter-generational use



Play integrated into mounded landscape



Increase park area suitable for passive recreation



Existing condition of Moore Park East

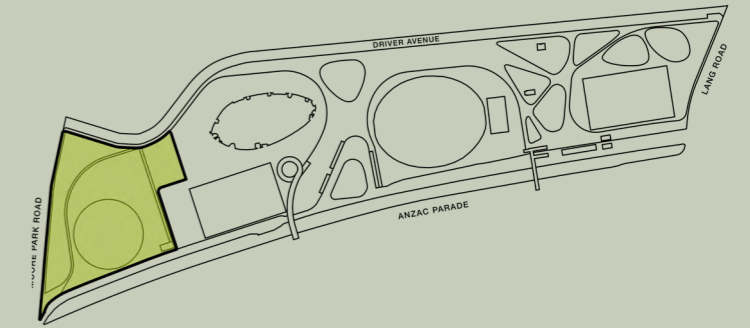

Moore Park East Landscape Plan

Legend

- 1 Community cricket pitch
- 2 New pathway to public amenities and circuit around Village Green
- 3 Mounded grass
- 4 Nature play
- 5 Dunefields Courtyard entrance

Moore Park Master Plan 2040 Key Takeouts

Enhance green open space following progressive parking removal

Village Green

Nature play with seasonal understorey planting

Informal play

Places to stop and watch

Network of pathways for walking and cycling

Village Green



New shade trees

Spectator terraces

Community cricket pitch

A new home for community sport

4 Key Areas

Exploring Moore Park East

Kippax Lake

Kippax Lake is the jewel of Moore Park East. In this area the plan seeks to enable greater interaction with water picnic areas and places for low key gatherings along with nature play and increased understorey planting.

Country-centered Design Opportunities

Kippax Lake

Planting on the outskirts of the lake filters and cleans the water before it enters the lake, creating a thriving ecosystem for local birds and animals.

Kippax Lake enables community to come together in a more passive and mindful way. Similarly, to how people would come together to weave. Weaving allows for calm and relaxation, as well kinship practice and storytelling, improving spiritual health and wellbeing.



Turf next to lake for relaxing

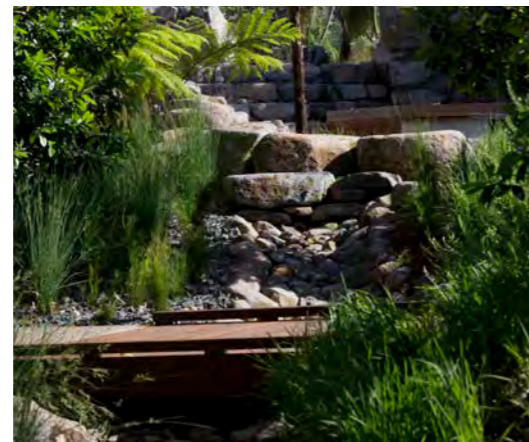

Design natural systems to improve water quality



Integrated art, play and education



Opportunities for art



Existing condition of Moore Park East

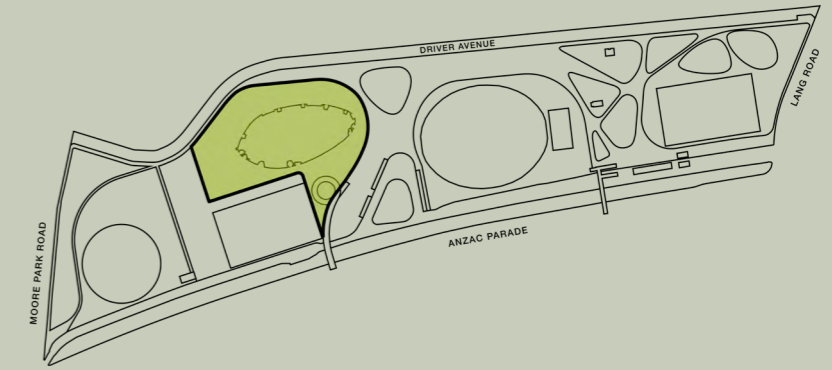

Moore Park East Landscape Plan

Legend

- 1 Turf area retained
- 2 Kippax Lake heritage drinking fountain retained
- 3 Swan protection area retained
- 4 New understorey planting + trees
- 5 Discovery trails + dry creek beds
- 6 New trees and landscaping around Tibby Cotter Bridge

Moore Park Master Plan 2040 Key Takeouts

Maintain, enhance and interpret the historical Kippax Lake while maintaining its importance as a destination for social and cultural activities

Introduce appropriate aquatic plantings to maintain a healthy aquatic habitat

Kippax Lake

New trees and landscaping

Turf next to lake for relaxing

Lake's natural beauty at the heart of Moore Park East

Enhancing the ecological story of Country



Kippax Lake Field

Improved field

Comfortable spectating areas

New lighting

Spectator mound



4 Key Areas

Exploring Moore Park East

Driver Avenue

Driver Avenue and connections to public transport and surrounding neighbourhoods have been considered in event mode and everyday mode, as well as in combination. The increasing frequency of high-profile events through the day and night at Moore Park is a significant consideration in terms of balancing path widths, safe crowd control and non event activities to ensure Moore Park East is a beautiful and multi-functional park.

Moore Park East lighting, wayfinding and access strategies will be developed in following stages to further refine the design.



Existing condition of Driver Avenue

Legend

	CBD/Randwick Light Rail		Meeting places
	Moore Park Bus Link		Gateway Entrances
	Sports Stadiums		Entrances to venues
	Entertainment Venues		Level access across Driver Avenue
	Retail		2-way vehicular road
	Carparking		Major connections (minimum 6m width)
	Shared space for pedestrian and cyclists with updated wayfinding and increased number of bicycle parking		Minor connections (1.5 - 4m width)

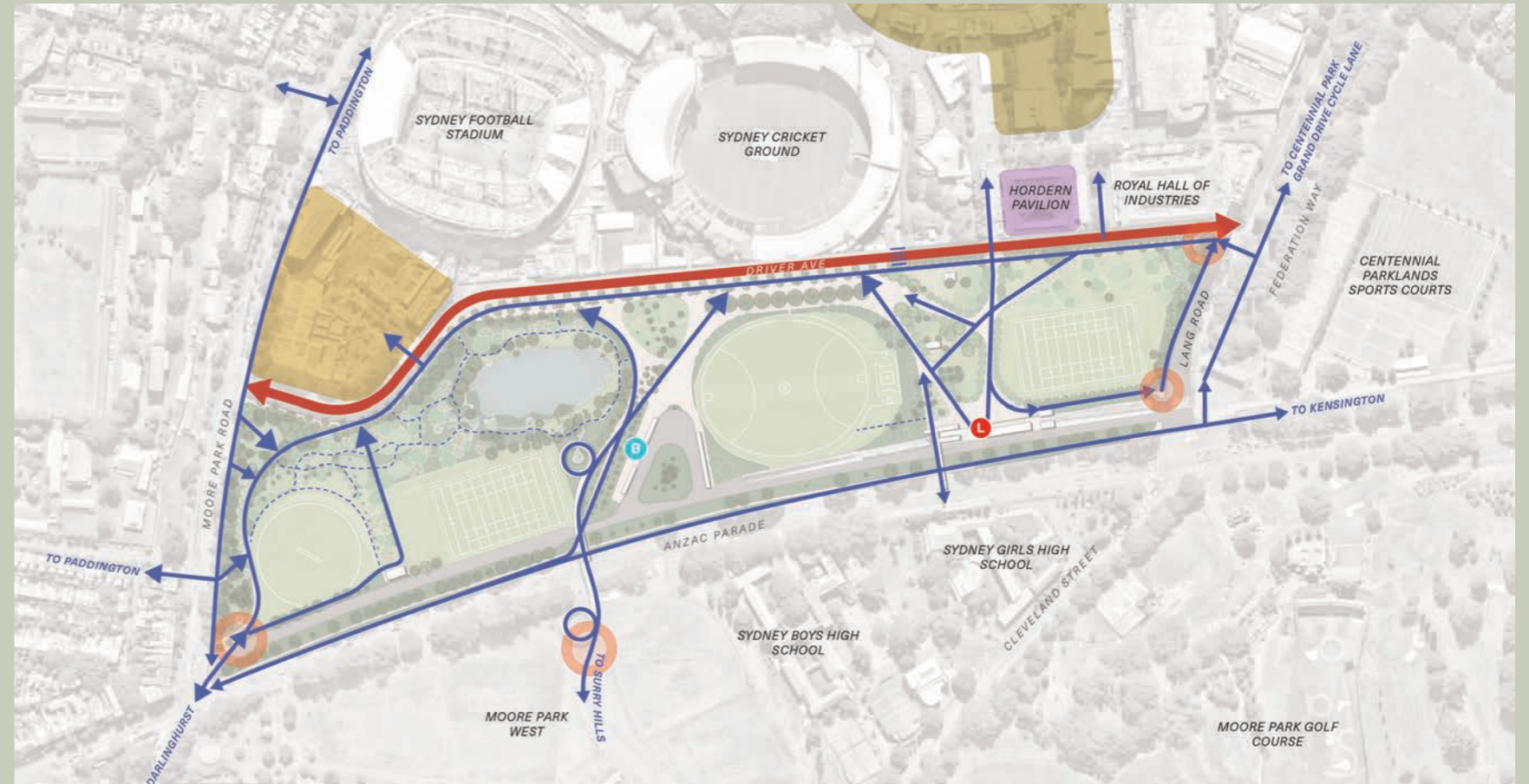

Everyday movement and connections

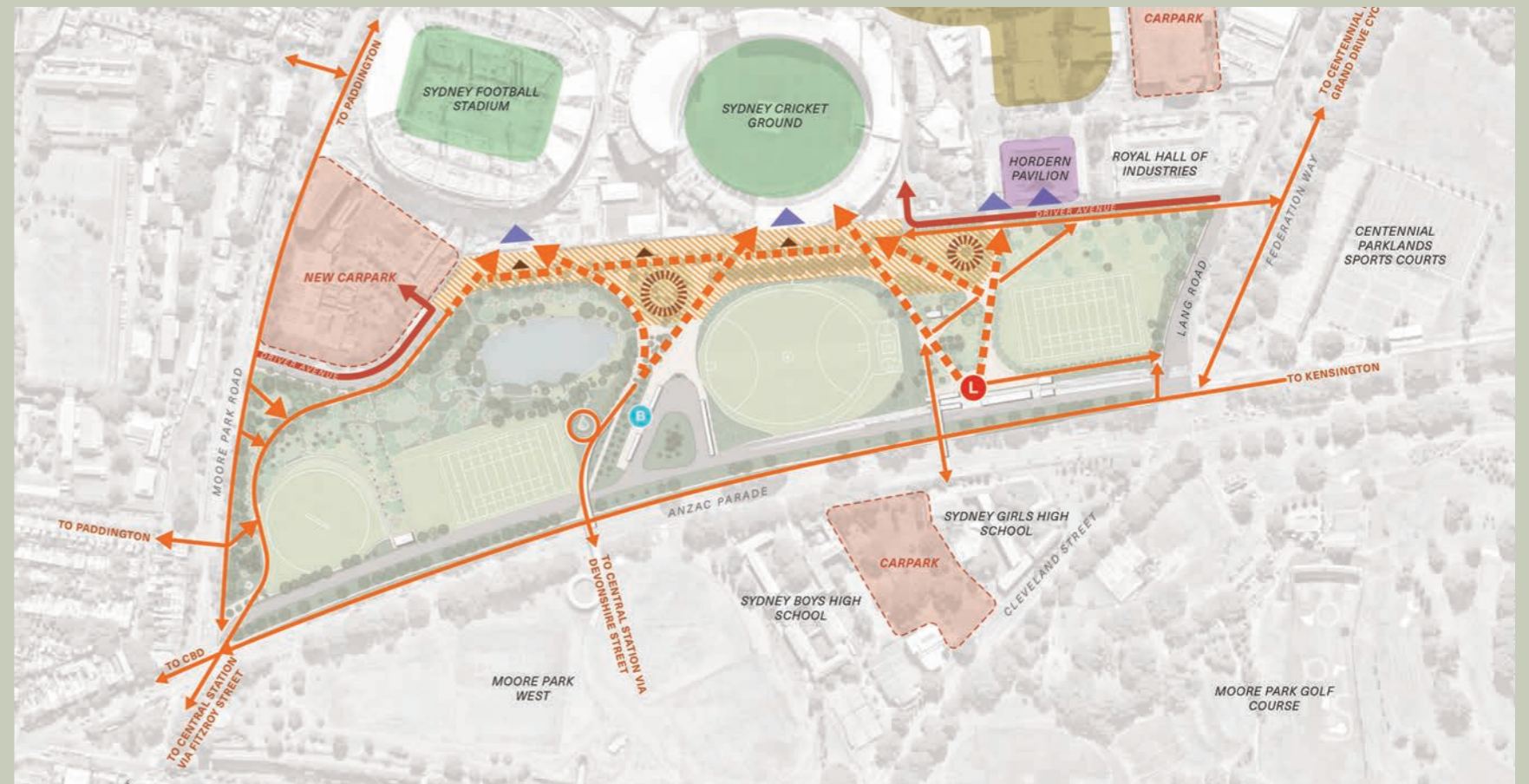

Event day movement and connections

4 Key Areas

Exploring Moore Park East

Driver Avenue

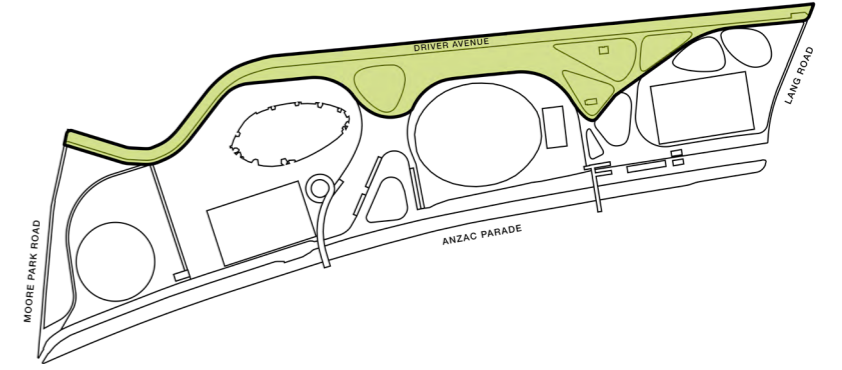

The Landscape Plan is focused on improving the pedestrian experience by removing clutter, providing level access, and creating a greener, more comfortable place to be.

Legend

- | | | | |
|---|--|---|------------------------------------|
| 1 | New footpath connecting to Moore Park Road | 7 | WSUD treatment along Driver Avenue |
| 2 | The Meeting Spot | 8 | Reduced carriageway width |
| 3 | New trees along Avenue | 9 | New zebra crossing |
| 4 | Existing event plaza | | |
| 5 | Flush kerb vehicular shared zone | | |
| 6 | Potential adaptive re-use of heritage tramshed | | |



Ample space for market events



Site wide lighting strategy

4 Key Areas

Exploring Moore Park East

Driver Avenue

Opportunities exist to improve the character and amenity of Driver Avenue through the landscape design, shifting the focus from vehicles to pedestrians and cyclists.

- Moving kerb alignment Eastward creating space for a generous footpath/shared zone
- Additional park space is claimed from Driver Avenue
- Driver Avenue's carriageway and parking widths reduced to Australian Standards while functional requirements not impacted
- Slow speed environment with 'shared zone'
- WSUD planting and additional trees to be integrated into streetscape

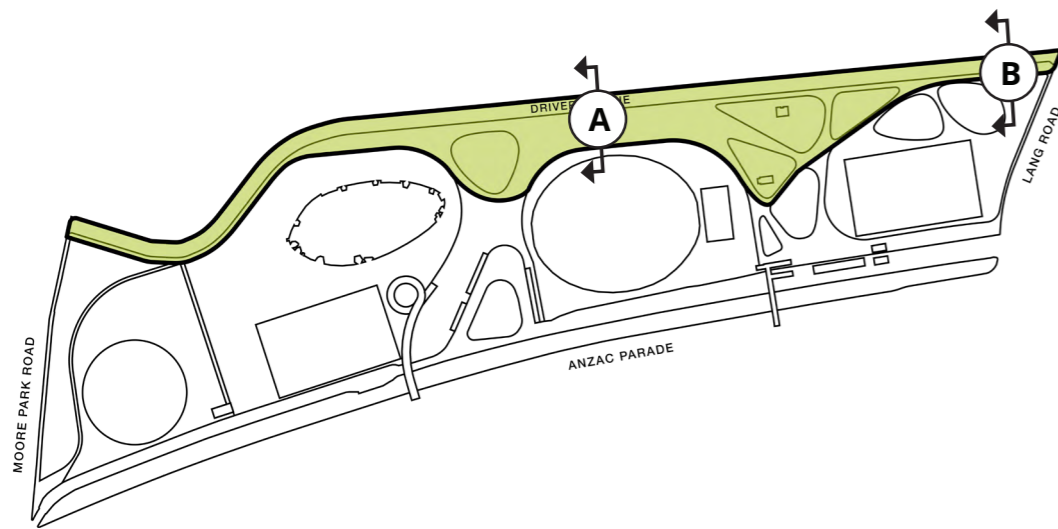

Robust street furniture for varied uses



Accessible amenity

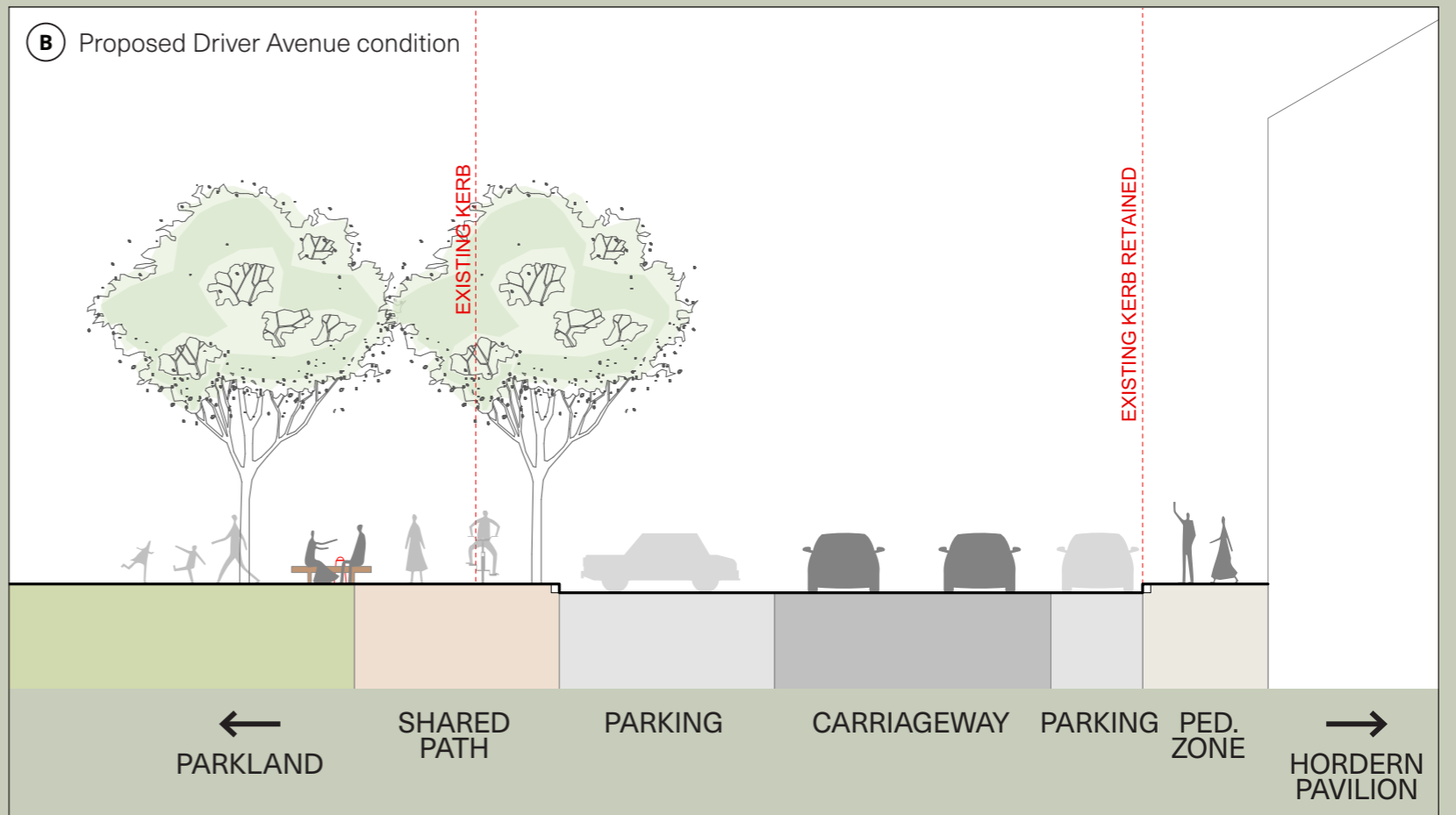
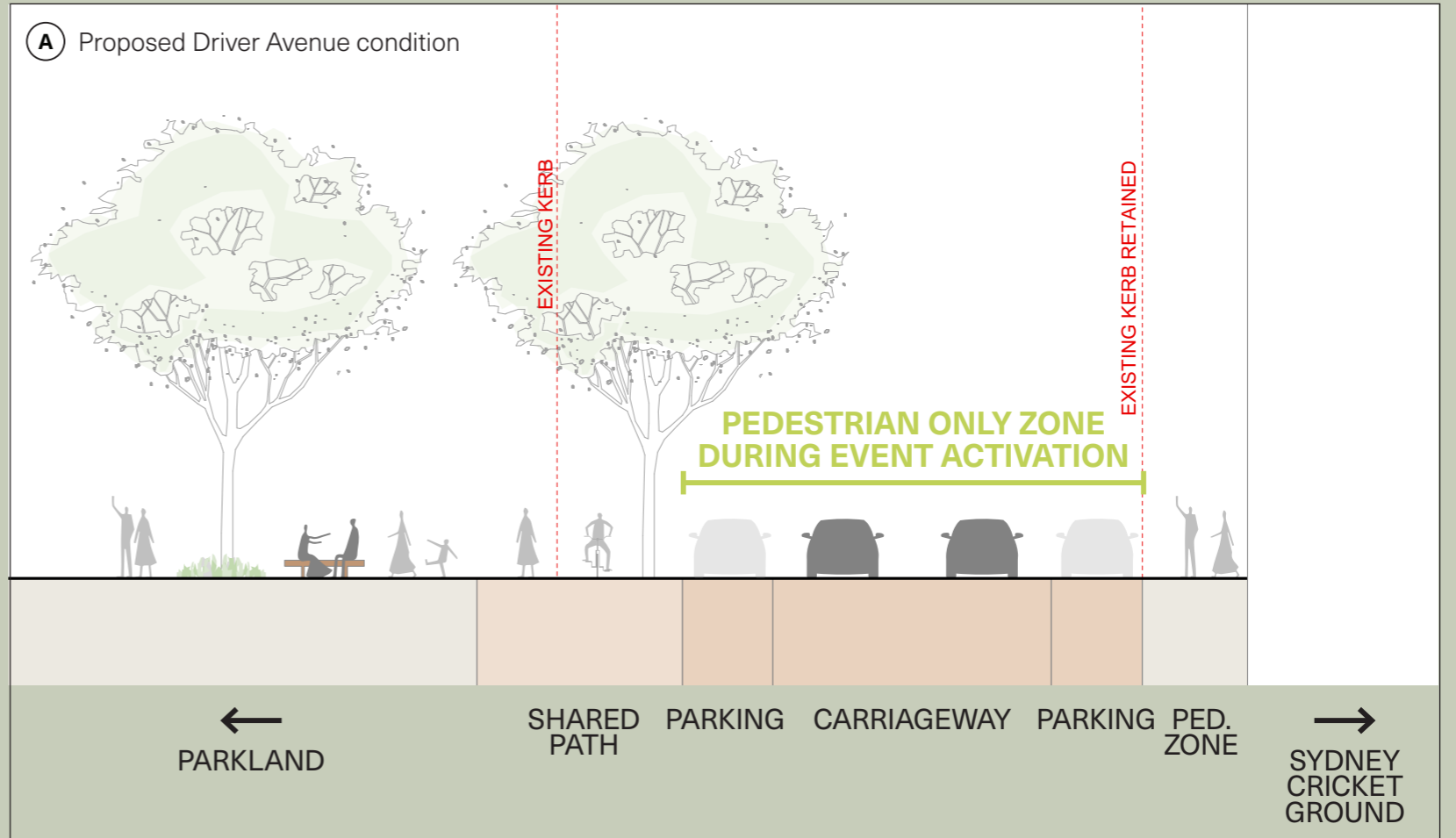

Driver Avenue

Well lit path to event destinations

Shady and accessible

Opportunity for temporary activation during event days

4 Key Areas

Exploring Moore Park East

Active Play

The Landscape Plan proposes a second play area at Moore Park East that provides a range of physical challenges for (older) children, as well as games to encourage multi generational play, within a natural setting.

Country-centered Design Opportunities

Inspired by Country's natural forms, textures, and colours.

Reflecting the endemic landscape through eco tones of plants and geology, patterning of key plant species, and the form of seating and skate edges inspired by the sand dunes

Opportunity to collaborate with teenagers from the local First Nations community. Input into design and facilities will encourage use, connection, and ownership of the space.



Use of local materials



Play integrated into parkland setting



Integrated into parkland setting

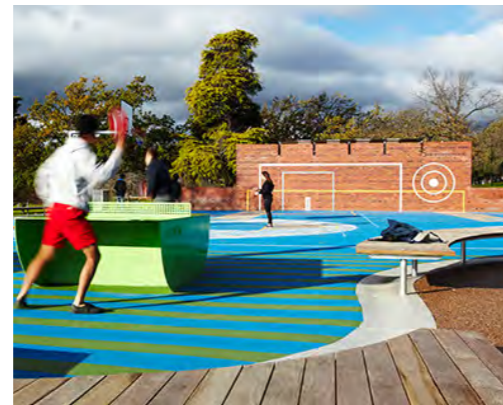

Intergenerational play



Existing condition of Moore Park East

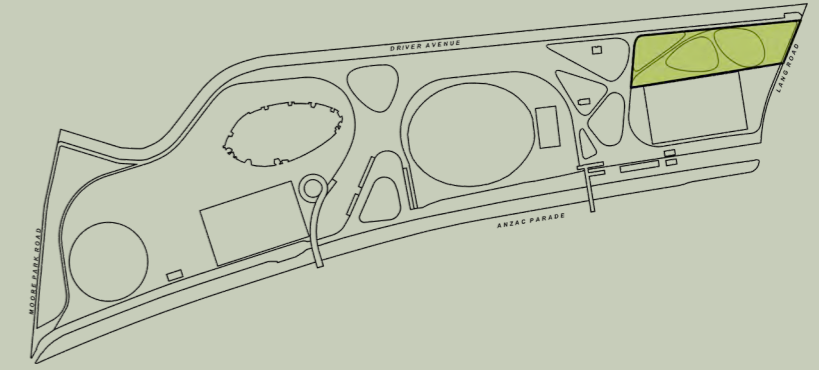

Moore Park East Landscape Plan

Legend

- 1 High performance Showground Field
- 2 Active play area
- 3 Upgraded entrance to park
- 4 Widened footpath on Driver Avenue
- 5 Buffer planting

Moore Park Master Plan 2040 Key Takeouts

Improve pedestrian access and dedicated cycle path connections



Centennial
Parklands